



# The Rose Garden Grand Suite

AT PENDLEY MANOR HOTEL

---

**PENDLEY MANOR**  
TRING







# Contents

- 1 Welcome to Pendley Manor
- 2 The Rose Garden Grand Suite
- 3 Our Marquee
- 4 Weddings
- 5 Layout & Specification
- 6 Banqueting Layout
- 7 Cabaret Layout
- 8 Theatre Layout
- 9 Specifications
- 10 Find Us

## Welcome to Pendley Manor

Enter the enchanting tree-lit driveway which welcomes you before you approach the quintessential English Manor House, enveloped with immaculate lawns, landscaped gardens and wooded surroundings. Reconnect with the great outdoors, family and friends.

The site of this sumptuous Grade II-listed Manor dates back over 1000 years, rising from a peaceful forest glade in 35 acres of rural Hertfordshire.

A stunning and sophisticated hideaway housed in a Tudor revival building featuring historical elements, brought seamlessly into the 21st century.





## The Rose Garden Grand Suite

Introducing our brand new Pendley Manor Rose Garden Grand Suite.

**Our vision is simple - to provide the most astounding and flexible marquee event space.**

This stunning space is ideal for celebrating personal milestone events, weddings, fashion shows, gala dinners, launches and large-staged events. One of the largest venues in the UK, The Rose Garden Grand Suite at Pendley Manor has excellent accessibility from main UK towns, available year-round.

This venue really lends itself to any event brief. Complete with a spacious foyer and a unique structure, which seamlessly blends into its surroundings, the Rose Garden Grand Suite lets your event stand out.

The grand structure can accommodate from 150 to 600 guests. Finished with oak effect flooring throughout, boasting high ceilings and plenty of natural light, you can execute your décor visions perfectly. With a list of popular suppliers from florists to caterers, you have access to a fully functioning kitchen, ample preparation space and layout options for all event possibilities.

“It’s clear that you are about to experience something out of the ordinary”

“  
The Rose  
Garden Grand  
Suite will turn  
heads for all  
the right  
reasons  
”



# Layout & Specifications

|  | SET UP STYLE | CAPACITY IN PRE-FUNCTION AREA | CAPACITY IN MAIN AREA |
|--|--------------|-------------------------------|-----------------------|
|  | Banqueting   | 160                           | 500                   |
|  | Theatre      | 280                           | 600                   |
|  | Cabaret      | 128                           | 400                   |

While this is a blank canvas for you to create your bespoke event, here are some suggested floorplans:

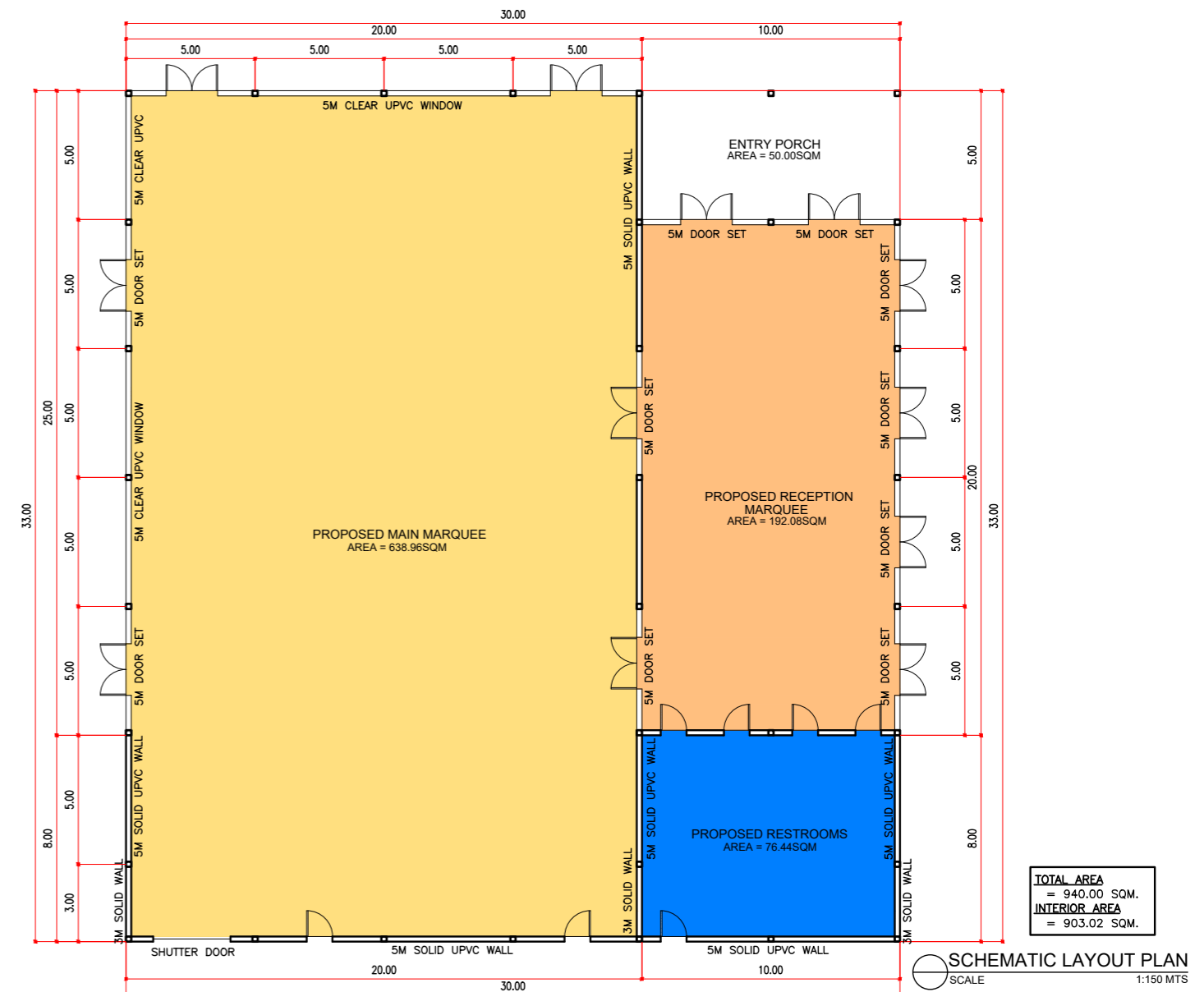

## Weddings

You've found the perfect partner, and now you've found the perfect place to celebrate your love. We're here to make your dream wedding a reality. Say "I Do" in our outstanding grounds and Rose Garden Grand Suite, the ideal venue for your wedding. From your wedding breakfast to your reception, the detailed planning and appreciation of cultural imperatives from our dedicated events team means your event and customs are taken care of as you focus on exchanging your vows and celebrating with your dearest.



# Banqueting Layout

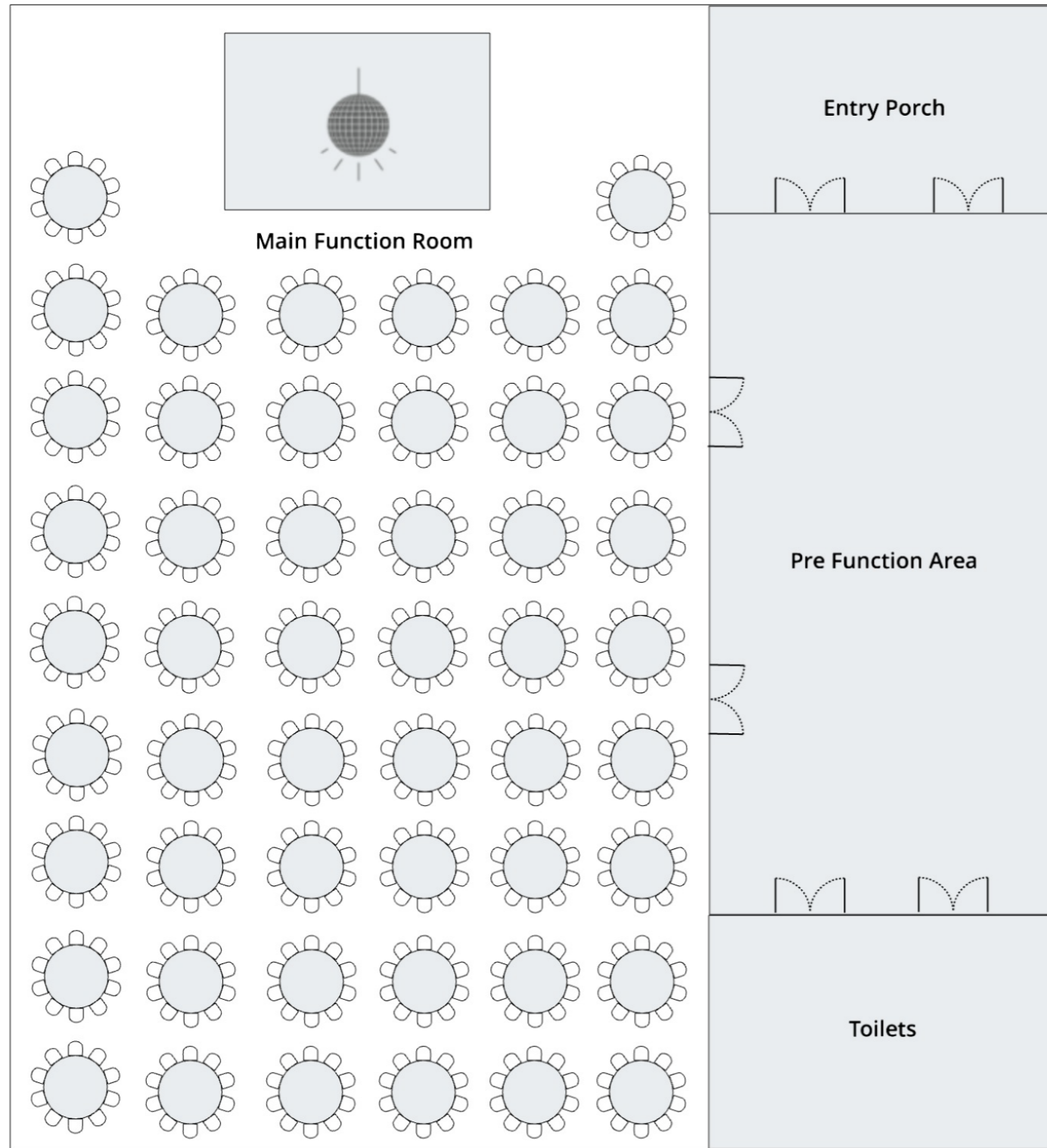

# Cabaret Layout

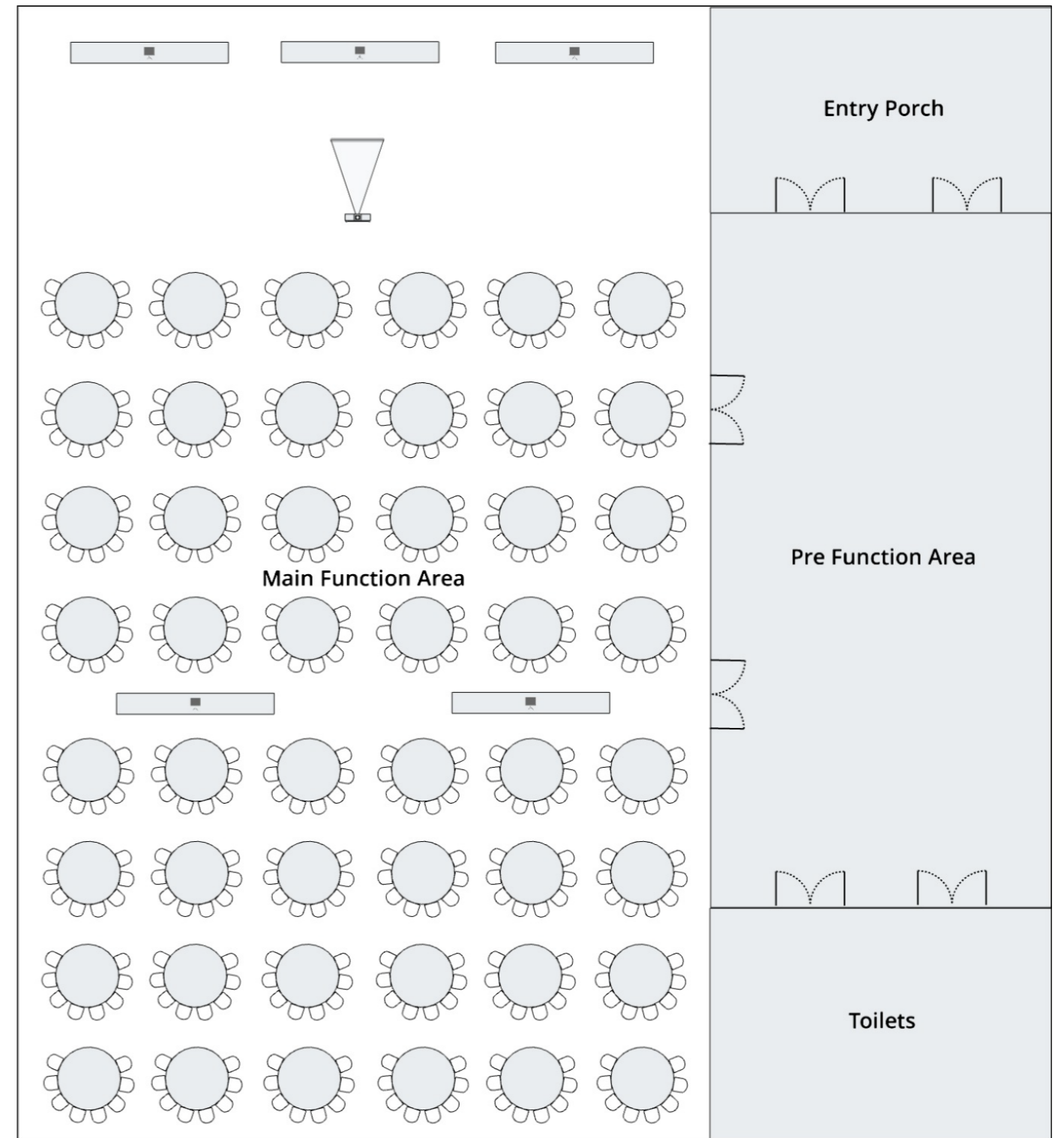

# Theatre Layout

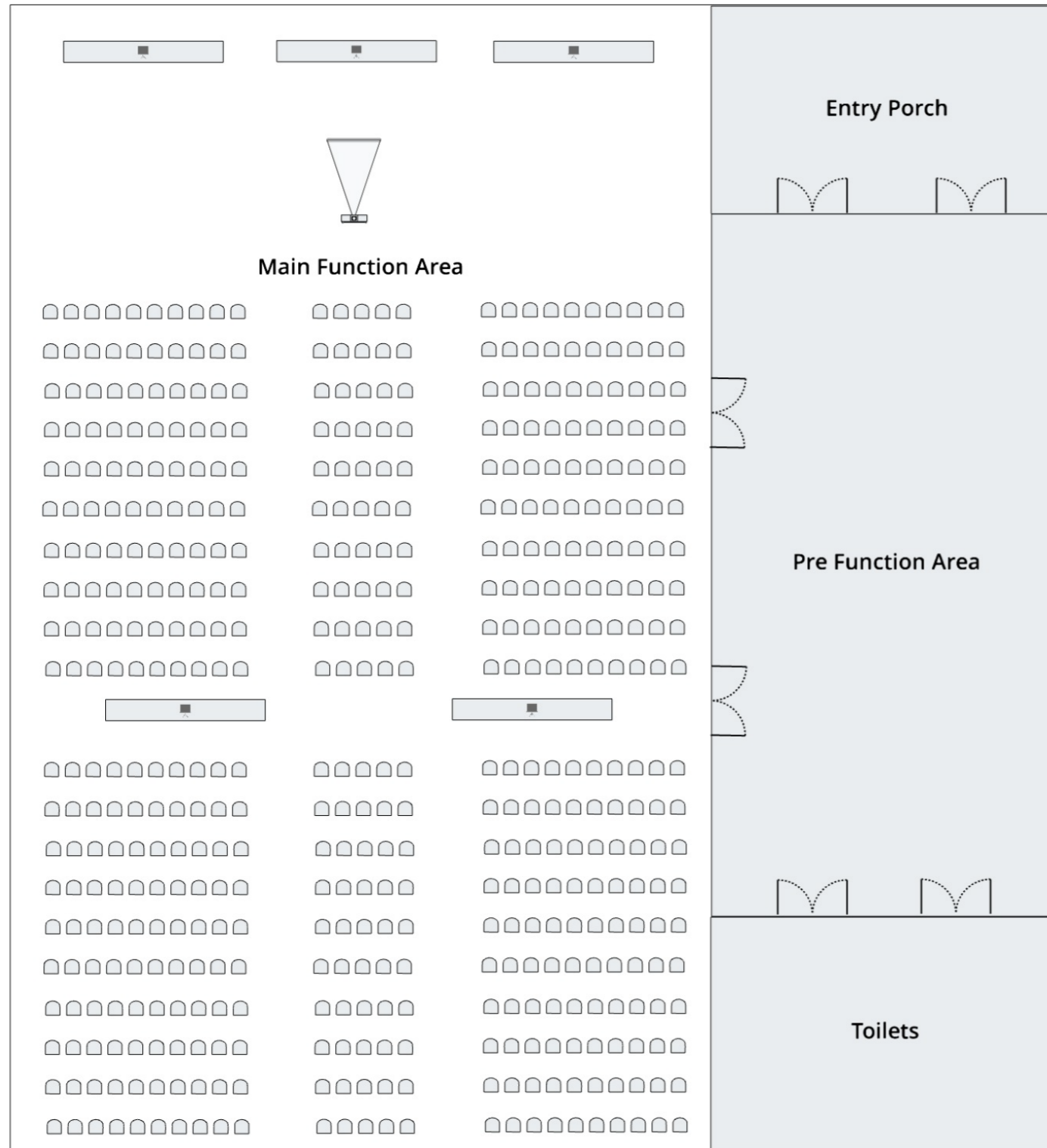

# Specifications

- 6ft tables and Chiavari chairs for up to 500 guests
- Crockery, cutlery and glassware
- Linen
- Neutral flooring
- Kitchen equipped to cater for up to 500 guests
- Chandelier lighting
- WiFi
- Car parking
- Air conditioning and heating
- Use of Pendley Manor grounds for photographs
- Honeymoon suite for wedding couple
- Bedroom for Bride to get ready
- Discounted wedding rate for guests the night of the wedding
- Dedicated coordinator to assist with planning of the day
- Onsite manager to assist on the day
- Welfare cabin for catering staff
- Toilets including disabled toilet
- Disabled access

# AV Specifications

- Zone Array speakers
- Powersoft Duecanali 4804 – Amplifier
- Symetrix Prism 16X16 – Frequency Specific Process Limiter
- Symetrix ARC3 – Remote wall mounted Volume Controller
- Symetrix X 10 Bluetooth Device
- Reinforcement Speaker system and wireless microphone
- 8 inch reinforcement speaker
- Powersoft Quattrocanali 2404 Amplifiers
- Sennheiser EW100 G4-835-S Handheld Mic System
- DJ Monitor Speaker system
- AUDAC VEXO112
- Speaker stands
- Powersoft Duecanali 804
- Compact 18” High Performance Subwoofer
- Tops 15” high-performance 2-way loudspeaker
- Powersoft Amplifer 4804





# Find Us

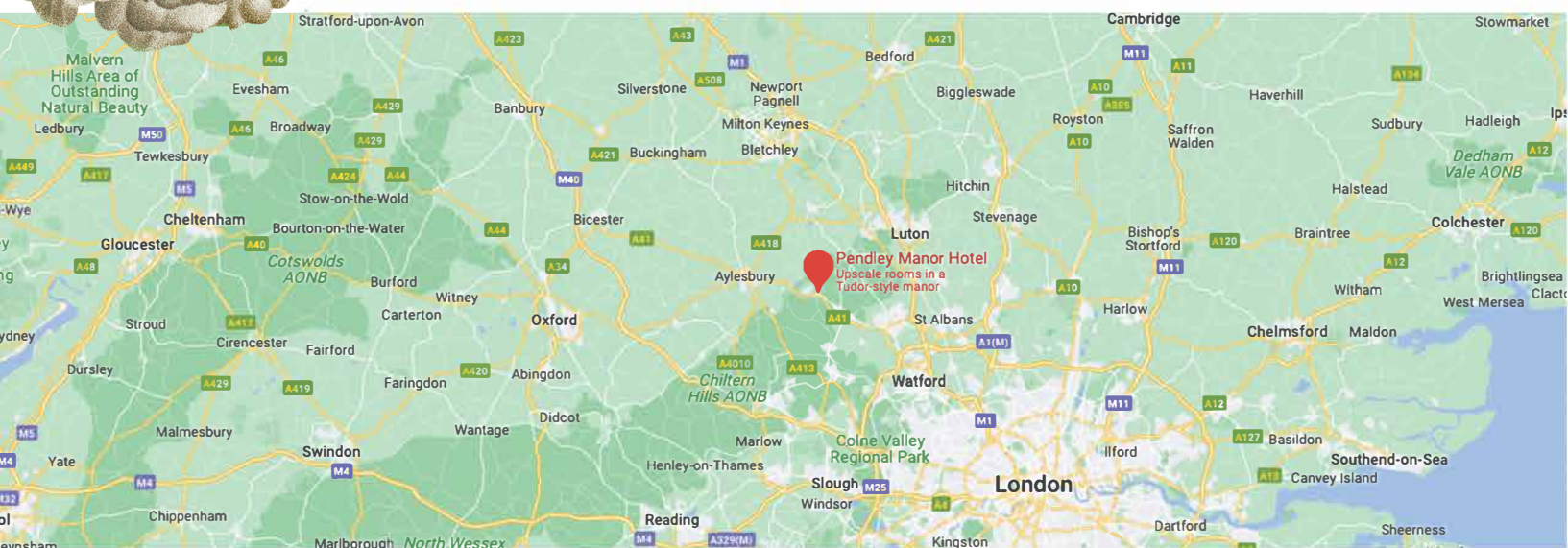

Our location is little more than an hour from Central London, very close to the M1 and M25 motorways and within adjacency to major UK towns.

Pendley Manor Hotel,  
Cow Lane, Tring,  
Hertfordshire, HP23 5QY